

# Parcel Map

## Door County, Wisconsin

Section - Town - Range

# 353328

Leading Tax Parcel Number

**018-04-353328**

### Town of Liberty Grove

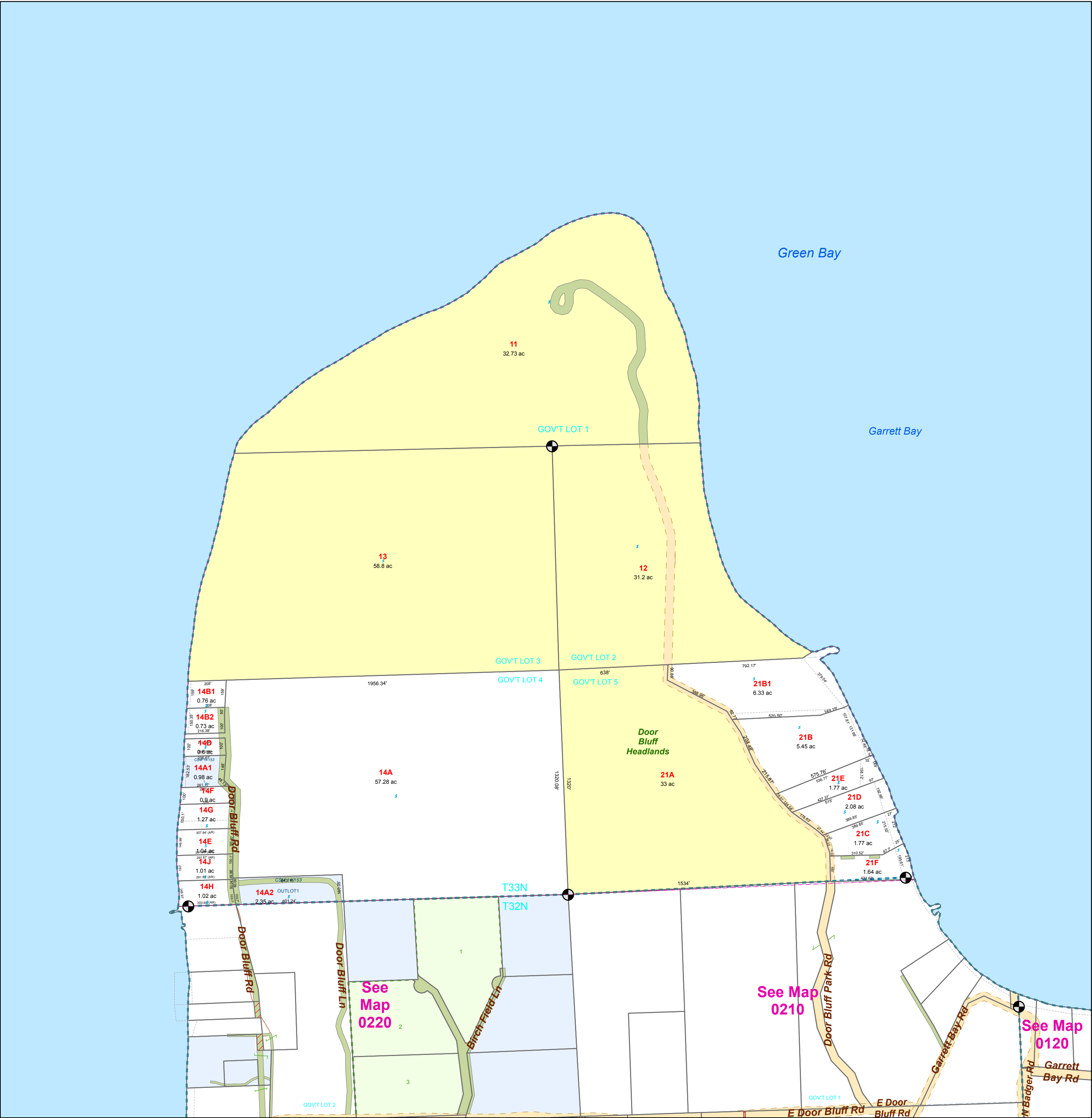
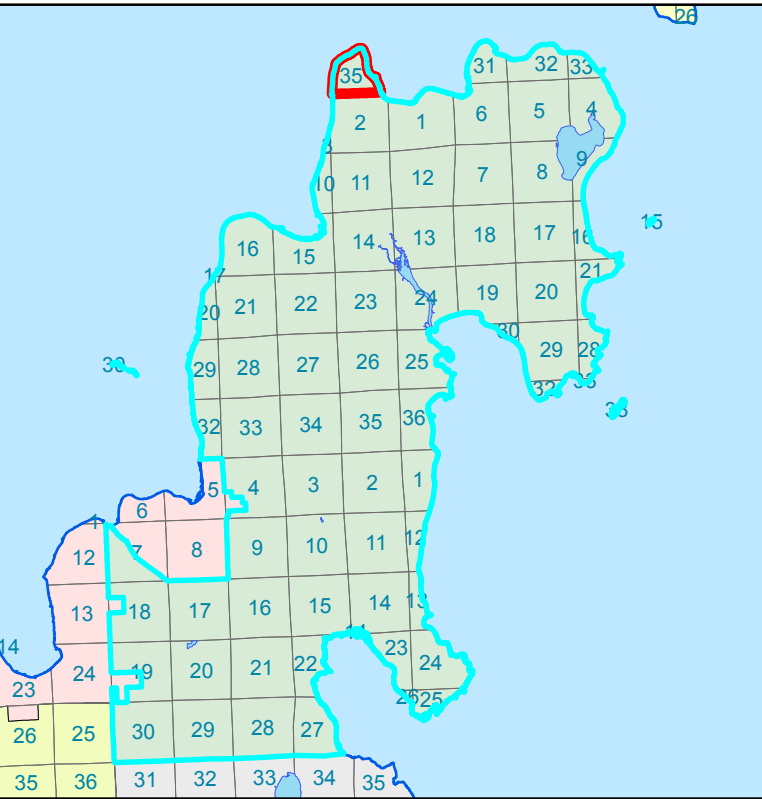

**Legend**

- Section Corner
- Tax Parcel
- Gap
- OverLap
- Reference Line
- PLSS Quarter Sections
- Section
- Easement
- Right Of Way
- Lot
- Condominium
- CSM
- Subdivision

**Municipal Type**

- City
- Town
- Village

Trailing Parcel ID Number  
**11A**

Deeded Acreage  
1.25 ac

Plat of Survey on File  
5

N

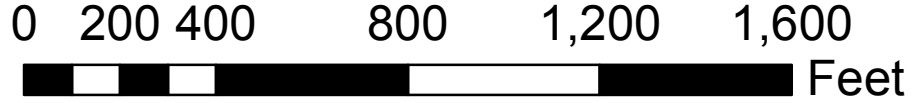

Print Scale: 1"=400'

Note: This map is only as accurate as the public records from which it was prepared and is limited to the quality of the data used. It is NOT intended to be a substitute for an actual field survey. Maps were developed through the Door County Land Information Office and are maintained by the Real Property Listing Office to aid tax assessment functions.

Municipality\_MapNumber  
018\_35332800

Date: 10/11/2018

Town 33 North  
Range 28 East  
Section 1/4 - 1/4  
**3500**