



EXISTING CONDITIONS

- 24 advisories/closures 2003–2006
- High average E coli count
 - o Wave height correlation
 - o Low, flat beach provides large swash zone and prevents infiltration
 - o Surface runoff from parking lot runs onto beach
 - o Pier attracts birds and creates area of stagnant water and cladophora trap
 - o High bird count
 - o Moderate cladophora accumulation

LEGEND

- PROPERTY LINE
- - - - - EXISTING CONTOURS (NGVD29 ELEV.)
- EXISTING SURFACE WATER FLOW
- ⊙ SOIL BORING

**FRANK MURPHY PARK
EXISTING CONDITIONS PLAN**

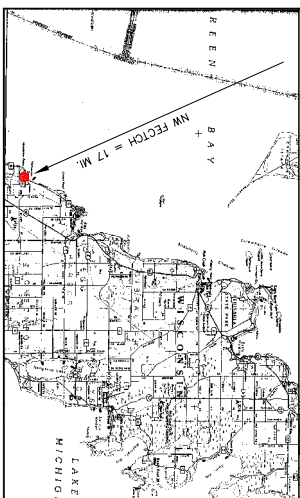

NOTE: PROPERTY LINE, CONTOUR AND ORTHO PHOTO INFORMATION SHOWN HEREON IS APPROXIMATE, AND WAS TAKEN FROM DATA PROVIDED BY THE DOOR COUNTY SOIL AND WATER CONSERVATION DEPARTMENT.

NO.	DATE	DESCRIPTION	SCJ	BY
2	4/11/07	ISSUED FOR SWCD REVIEW	SCJ	
1	4/2/07	TEXT AND LEGEND EDITS	SCJ	

EXISTING CONDITIONS PLAN

MILLER ENGINEERS SCIENTISTS
 5308 S. 12th Street
 Sheboygan, WI 53081-8099
 Phone 920-458-6164
 Fax 920-458-0369
 www.startwithmiller.com
 An Engineer/Owned Company

DOOR COUNTY
 BEACH STORM WATER MANAGEMENT
 FRANK MURPHY PARK
 EGG HARBOR, WISCONSIN

SCALE	DATE	BY	SCJ	SHEET
HOR. 1"=40'	1-23-07		SCJ	1
VER.	JOB 17326-A- MURPHY	OK	PGP	2