

POSSIBLE IMPROVEMENTS

- Best management practices
 - o Street/hard surface cleaning four times per year.
 - o Remove cladophora when significant amount accumulates in swash zone
 - o Implement storm water ordinances for future development
 - o Public Signage (No Pets, Don't feed the birds, Pick up trash)
 - o Daily to weekly beach grooming
- Beach Nourishment to increase infiltration, decrease swash zone width, increase water movement, and increase beach area
- Line edge of beach with dune grass to stabilize sand, increase infiltration, increase evapotranspiration, and detract birds
- Install bio-filter between parking lot and beach to infiltrate and filter "first flush" surface runoff
- Line parking lot with native vegetation to increase infiltration, increase evapotranspiration, and detract birds
- Remove part of rock jetty to increase water movement at beach and detract birds

LEGEND

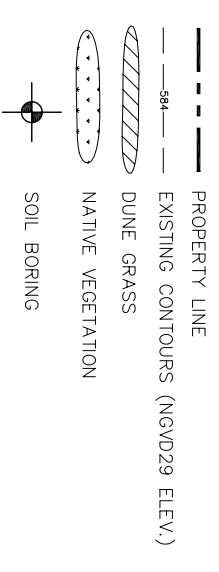

BEACH PROFILE A-A'

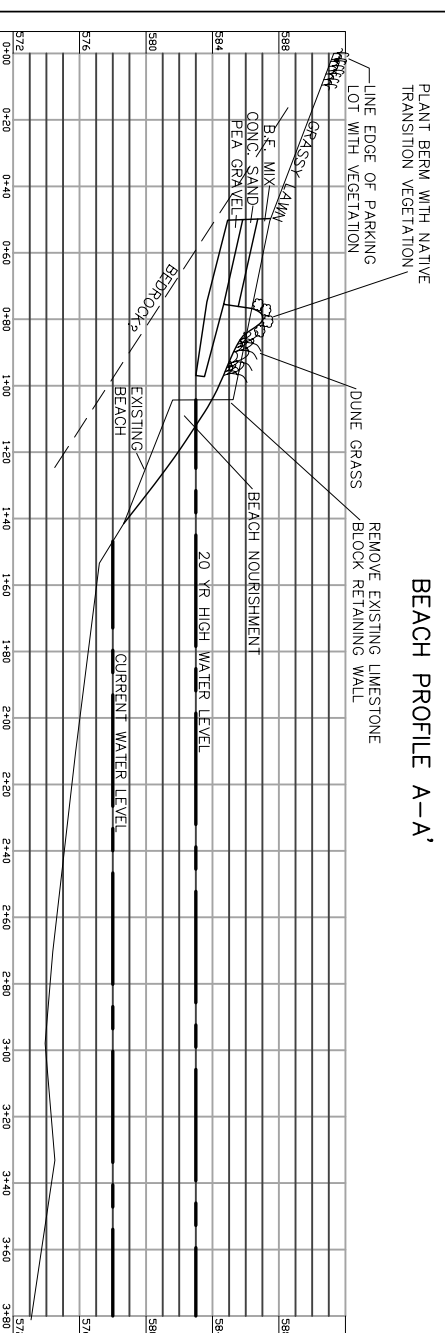

**EGG HARBOR BEACH
E. COLL REDUCTION CONCEPT PLAN**

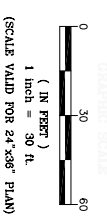
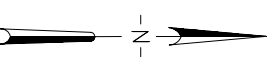

NOTE: PROPERTY LINE, CONTOUR AND ORTHO PHOTO INFORMATION SHOWN HEREON IS APPROXIMATE, AND WAS TAKEN FROM DATA PROVIDED BY THE DOOR COUNTY SOIL AND WATER CONSERVATION DEPARTMENT.

| | | | | | | | |
|-----|---------|------------------------|-----|------|----------|-----|-------|
| NO. | DATE | DESCRIPTION | BY | VER. | AS SHOWN | PGP | SHEET |
| 1 | 3/26/07 | GENERAL EDITS | SCJ | | | | 2 |
| 2 | 4/2/07 | TEXT AND LEGEND EDITS | SCJ | | | | 2 |
| 3 | 4/10/07 | ISSUED FOR SNOO REVIEW | SCJ | | | | 2 |

PRELIMINARY, NOT FOR CONSTRUCTION
CONCEPTUAL DESIGN
MILLER ENGINEERS SCIENTISTS
 An Employee Owned Company
 5308 S. 12th Street
 Sheboygan, WI 53081-6099
 Phone 920-458-6164
 Fax 920-458-0369
 www.storwithmiller.com

DOOR COUNTY
BEACH STORM WATER MANAGEMENT
EGG HARBOR BEACH
EGG HARBOR, WI

| | | | |
|---------------|-------------------------|-----|-------|
| SCALE | DATE | BY | SHEET |
| 1"=30' | 1-23-07 | SCJ | 2 |
| VER. AS SHOWN | JOB# 17326-B-EGG HARBOR | OK | 2 |