

POSSIBLE IMPROVEMENTS

- Urban best management practices
 - o Clean storm sewer inlets four times a year: vortechs unit (if applicable)
 - o Street/hard surface cleaning four times a year
 - o Remove cladophora when significant amount accumulates in wash zone
 - o Implement storm water ordinances for future development
 - o Public Signage (No Pets, Don't feed the birds, Pick up trash)
 - o Daily to weekly beach grooming
- Beach Nourishment to increase infiltration, decrease swash zone width, and increase beach area
- Line path and beach with dune grass to stabilize sand, increase infiltration, increase evapotranspiration, and detract birds.
- Install up to four Vortechs filter units to filter out debris and sediment from storm water prior to discharge
- Connect 2 existing storm sewer systems into one discharge pipe
- Extend storm sewer discharge pipe approximately 500 feet into bay.

LEGEND

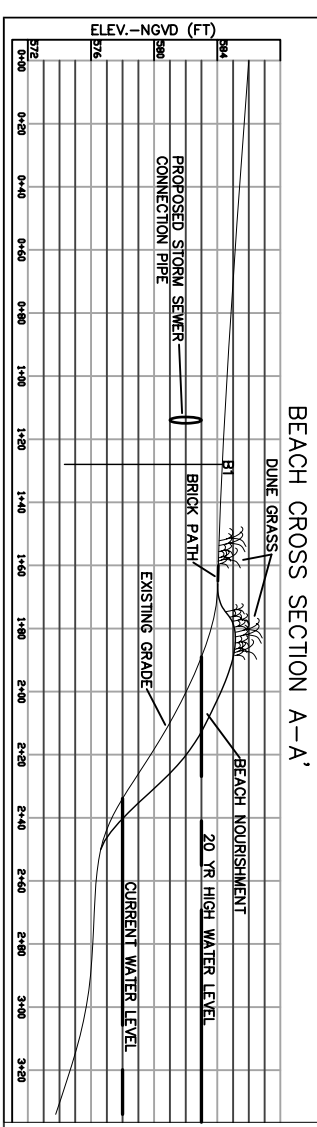
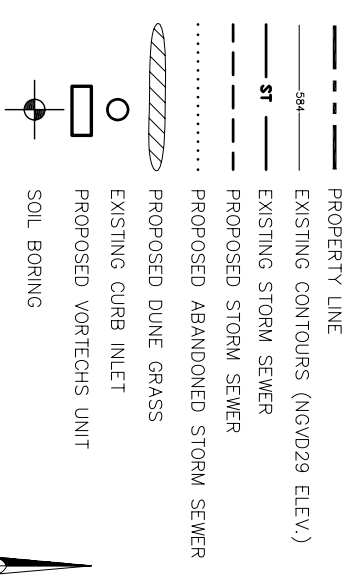

**OTUMBA PARK
E. COLI REDUCTION CONCEPT PLAN**

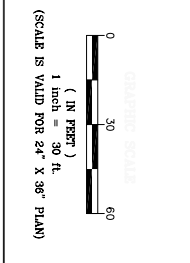

NOTE: PROPERTY LINE, CONTOUR AND ORTHO PHOTO INFORMATION SHOWN HEREON IS APPROXIMATE, AND WAS TAKEN FROM DATA PROVIDED BY THE DOOR COUNTY SOIL AND WATER CONSERVATION DEPARTMENT.

NO.	DATE	DESCRIPTION	BY
1	4/2/07	TEXT AND LEGEND EDITS	SCJ
2	4/11/07	ISSUED FOR SWCD REVIEW	SCJ

PRELIMINARY, NOT FOR CONSTRUCTION
CONCEPTUAL DESIGN

MILLER ENGINEERS SCIENTISTS
 5308 S. 12th Street
 Sheboygan, WI 53081-6099
 Phone 920-458-6164
 Fax 920-458-0369
 www.stortwithmiller.com

DOOR COUNTY
 BEACH STORM WATER MANAGEMENT
 OTUMBA PARK
 STURGEON BAY, WI

SCALE	DATE	BY	SHEET
1" = 30'	2/15/07	SCJ	2
JOB	DR	CK	OF
08917326-B			2
OTUMBA		PGP	2